

## 97200 Flame Check

The S&J 97200 Flame Check provides an in-line barrier against flame flashback in small gas lines. They are typically installed in pilot lines supplying fuel burning devices used in flares and waste gas burners. They are also used in vent piping servicing manometer pressure taps and diaphragm regulators.

Optimally, the flame check should be located as close as possible to the open end of the vent pipe or to the potential source of the flame. The flame check quenches in-line fires by lowering the gas temperature to below its ignition point. The 97200 provides safe, reliable fire protection with a woven wire design.

The flame check allows maximum flow with minimal pressure drop. It is also easily serviced and installed with pipe union housing.

Its aluminum and stainless steel components withstand the severest of process environments. The S&J 97200 is especially designed for hydrogen sulfide and hot, wet methane which are the main components of digester gas streams in municipal waste water treatment facilities.

### Specifications:

**Body:**

Aluminum or Stainless Steel

**Element:**

Stainless Steel

**Gasket:**

Nitrile Fiber

**Pressure Rating:**

25 PSIG

**Gas Application:**

NEC Group D

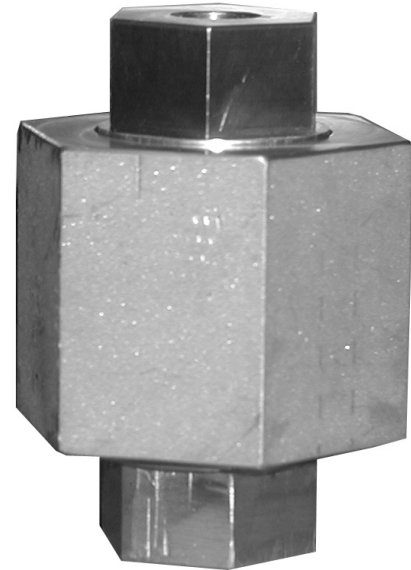

### Features

- Flame Flashback Prevention
- High Flow Capacity
- Standard Stainless Steel
- Sizes 1/4" Through 2"
- 25 PSIG Working Pressure

**Outline Dimensions**

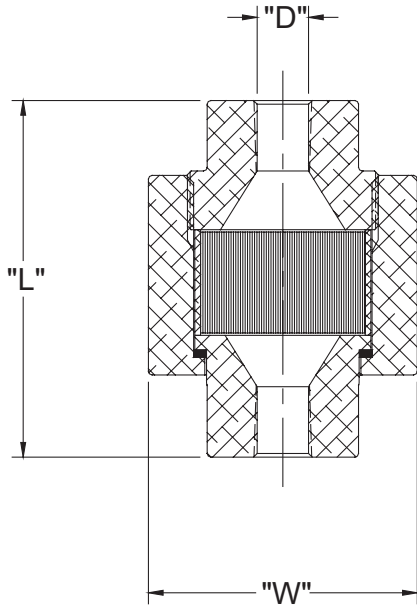

Dimensions (Inches [mm])							
Size Code		1	2	3	4	5	6
D	Nominal Pipe Size	¼ [6 m]	½ [13]	¾ [19]	1 [25]	1 ½ [38]	2 [51]
W	Width	2 [51]	3 ½ [89]	3 ½ [89]	3 ½ [89]	4 ¾ [121]	4 ¾ [121]
L	Length	3 [76]	3 ½ [89]	3 ½ [89]	3 ½ [89]	4 ½ [114]	4 ½ [114]
Shipping Weight		1	2	2	3	3	4

**Air Flow Capacity in Standard Cubic Feet per Hour**

Pressure Drop Inches W.C.	Line Diameter					
	1/4"	1/2"	3/4"	1"	1-1/2"	2"
0.25	39	54	78	148	316	886
0.50	62	91	129	260	536	1,430
0.75	80	124	176	353	716	1,877
1.00	96	151	213	443	892	2,236
1.25	107	175	247	519	1,032	2,562
1.50	117	193	271	596	1,165	2,863
1.75	126	204	294	659	1,288	3,115
2.00	133	213	311	720	1,395	3,279

All designs subject to change. Certified dimensions and specifications available upon request.

**97200 Ordering Guide**

**Model Number Selection**

The model number will have a base number **97200** followed by 2 digit numbers. These digits will represent 2 sets of option tables.

**97200 - AB**

**Table A - Line Size & Connection**

Option A	Line Size & Connection
1	1/4" NPT
2	1/2" NPT
3	3/4" NPT
4	1" NPT
5	1-1/2" NPT
6	2" NPT

**Table B - Body Material**

Option B	Element / Body Material
1	316 Stainless Steel / 316 Stainless Steel
2	316 Stainless Steel / Aluminum