

36" x 24" flat sealed composite cover with an aluminum frame.

For reference purposes only. This drawing is not a specification. Order against product code only. To enable continuous improvement of our products, the designs and specifications are subject to change without notice.

FIBRELITE 
PART OF OPW A  DOVER COMPANY

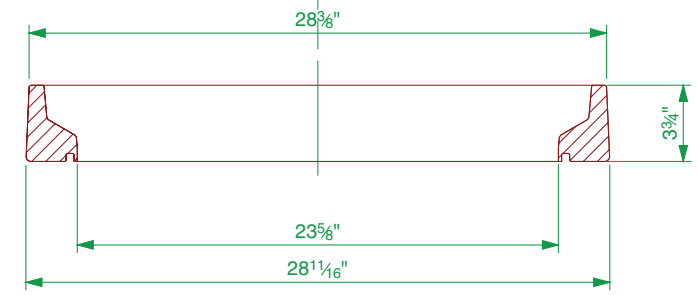
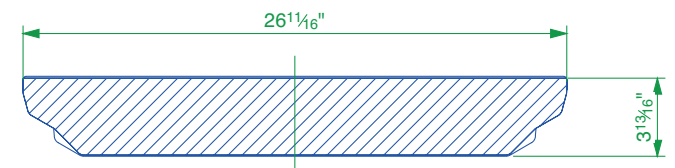
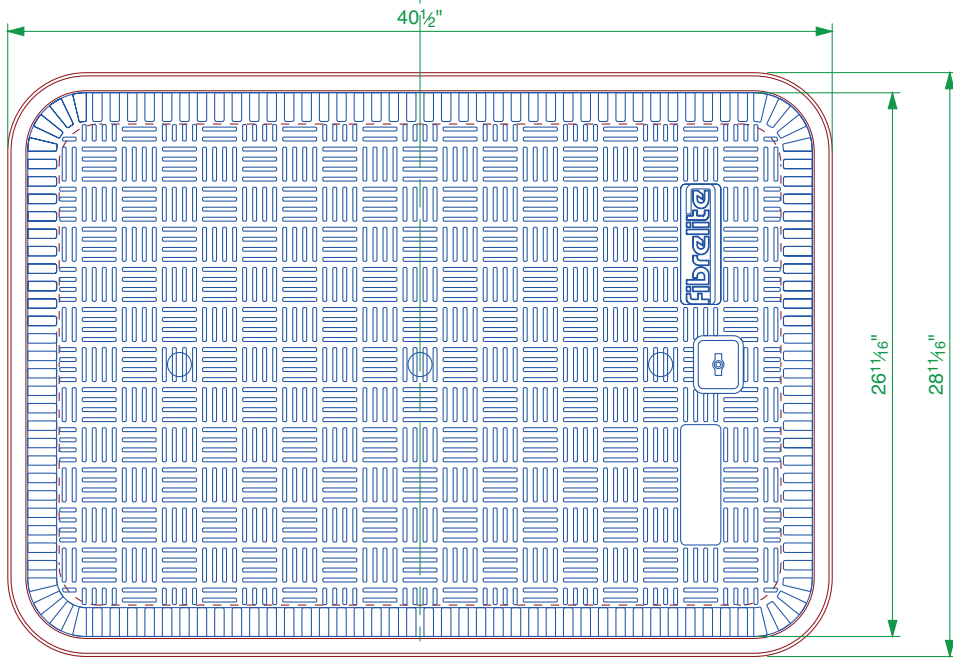
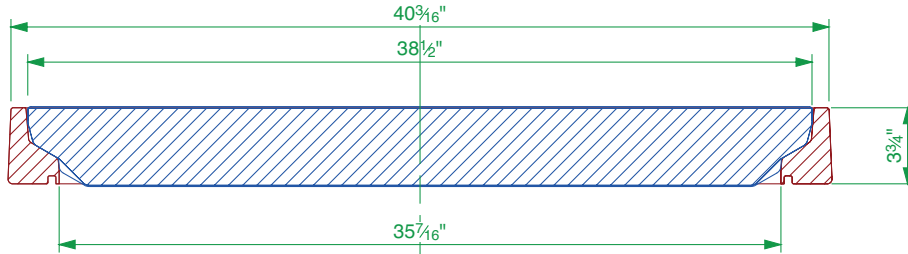

FIBRELITE COVER TYPE	LOAD RATING	TEST LOAD	POUNDS/FORCE	COVER WEIGHT
Light Duty (LD)	B125	125 kN	28,000	41.9 lbs
Standard Duty (SD)	C250	250 kN	56,000	61.7 lbs
Heavy Duty (HD)	D400	400 kN	89,000	84.9 lbs

36" x 24" flat sealed composite cover with an aluminum frame.

For reference purposes only. This drawing is not a specification. Order against product code only. To enable continuous improvement of our products, the designs and specifications are subject to change without notice.



CONCRETE

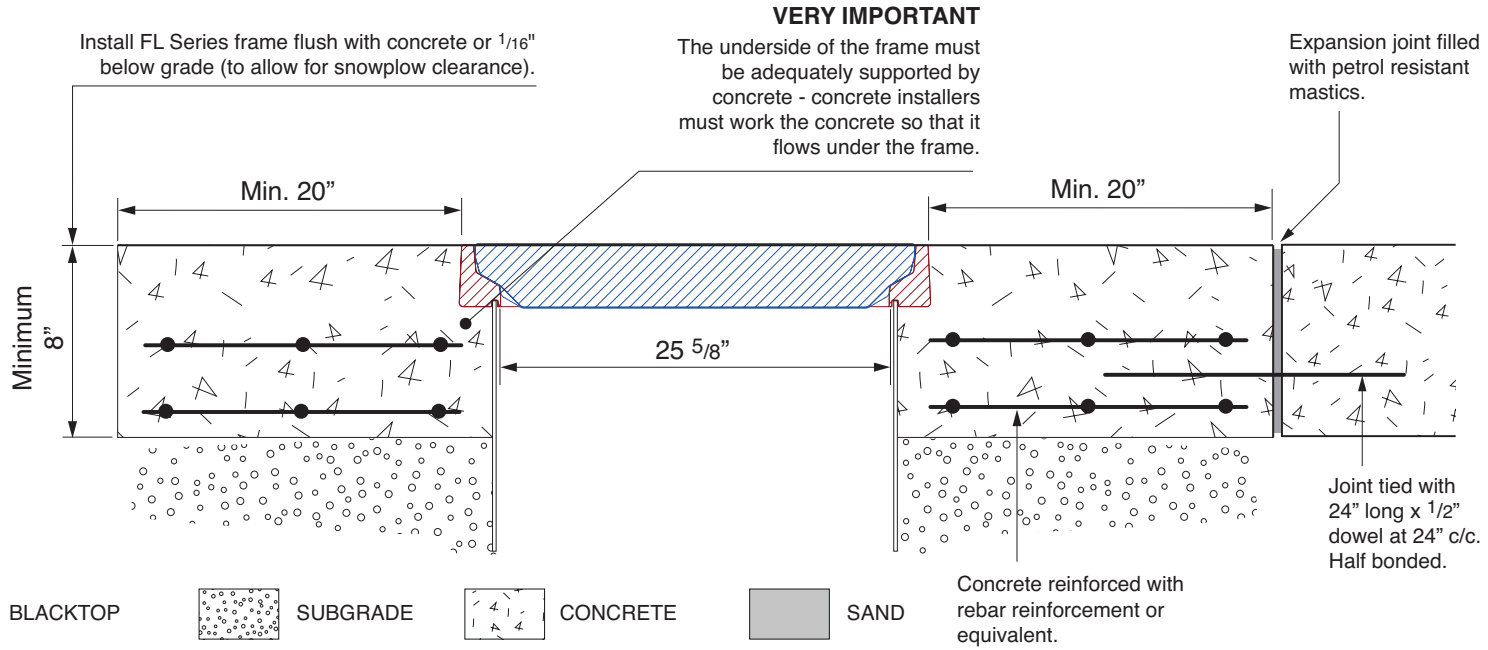

BLACKTOP

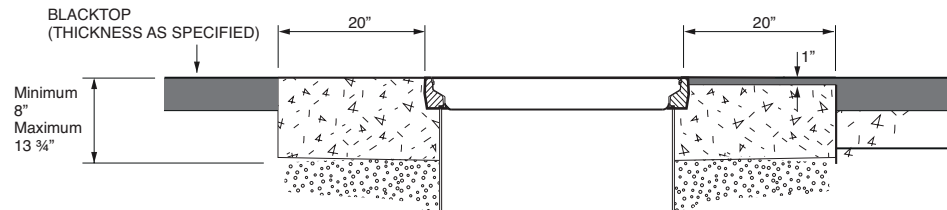

PAVING STONES / BRICKWORK

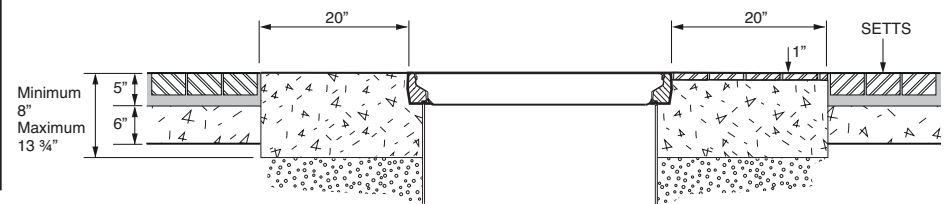

36" x 24" flat sealed composite cover with an aluminum frame.

For reference purposes only. This drawing is not a specification. Order against product code only. To enable continuous improvement of our products, the designs and specifications are subject to change without notice.

FIBRELITE 
PART OF OPW A DOVER COMPANY