

24" x 24" flat sealed composite cover with an aluminum frame.

For reference purposes only. This drawing is not a specification. Order against product code only. To enable continuous improvement of our products, the designs and specifications are subject to change without notice.

**FIBRELITE**   
PART OF OPW A  COMPANY

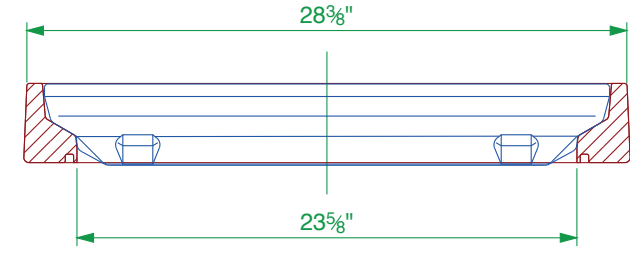
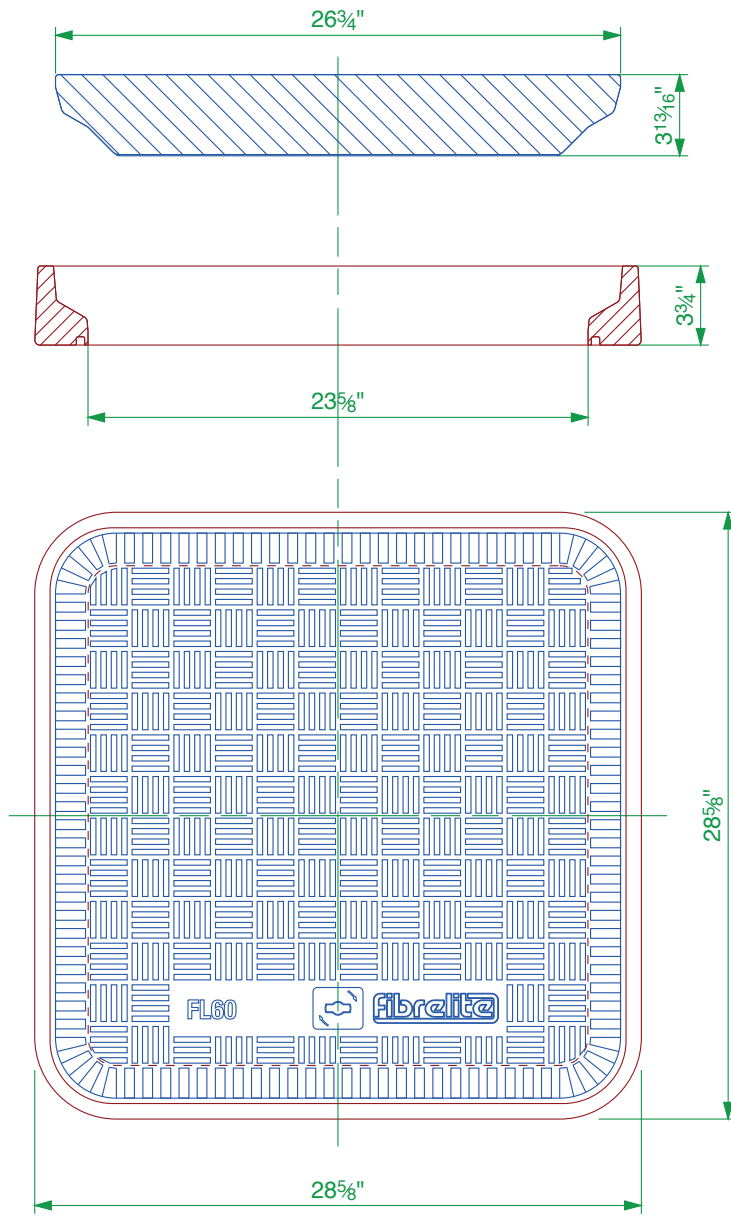

FIBRELITE COVER TYPE	LOAD RATING	TEST LOAD	POUNDS/FORCE	COVER WEIGHT
Light Duty (LD)	B125	125 kN	28,000	26.5 lbs
Standard Duty (SD)	C250	250 kN	56,000	44.1 lbs
Heavy Duty (HD)	D400	400 kN	89,000	52.9 lbs

24" x 24" flat sealed composite cover with an aluminum frame.

For reference purposes only. This drawing is not a specification. Order against product code only. To enable continuous improvement of our products, the designs and specifications are subject to change without notice.



# CONCRETE

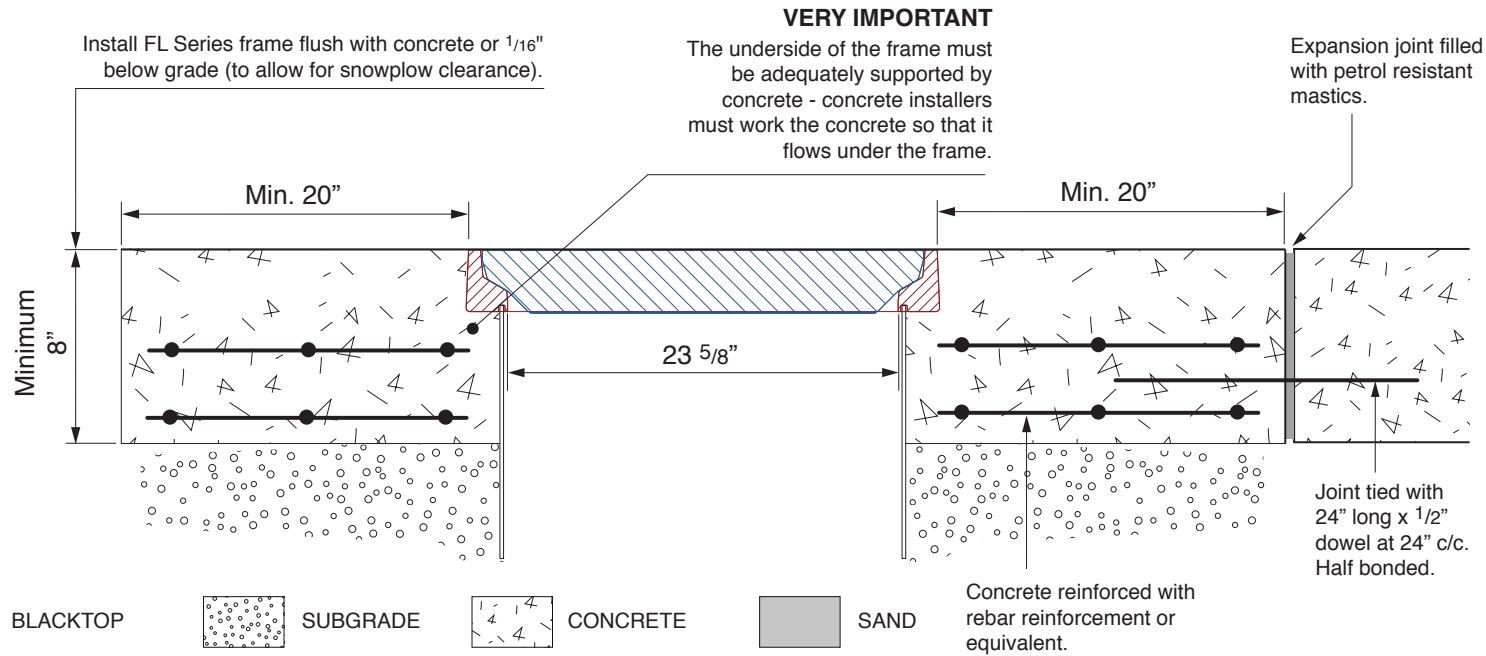

## BLACKTOP

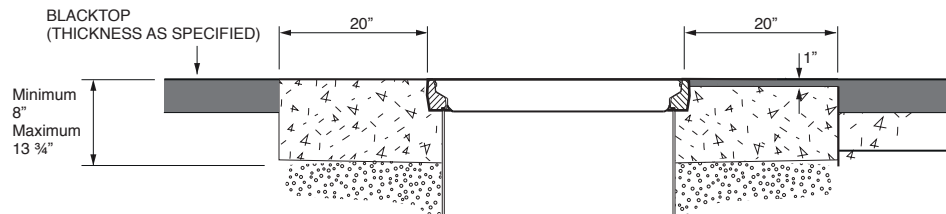

## PAVING STONES / BRICKWORK

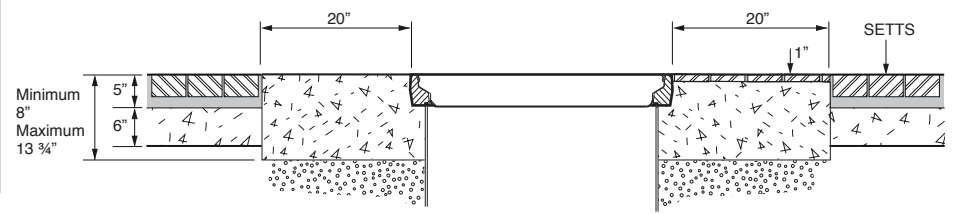

24" x 24" flat sealed composite cover with an aluminum frame.

For reference purposes only. This drawing is not a specification. Order against product code only. To enable continuous improvement of our products, the designs and specifications are subject to change without notice.

**FIBRELITE**   
PART OF OPW A DOVER COMPANY